



**FIRE BOX
CAPACITY**

COMFORTABLY FITS 6
PIECES OF WOOD*



**HEATING
AREA**

SUITABLE FOR
HEATING MEDIUM
TO LARGE AREAS



**EXTENDED
BURN TIME**

SUSTAINED BURN
CYCLE FOR LONGER
EVEN HEAT



**HASSLE FREE
MAINTENANCE**



**EASY
OPERATION**

COLERIDGE by Woodsman

The new Woodsman Coleridge is the latest edition to our leading range of new generation ultra clean burning log burners. Following on from the highly successful SERENE model, it continues our vision to bring to you the most user friendly, easy to maintain, value for money wood burners which can be installed in even the tightest of clean air zones in the country.

Simplicity is the key and the Coleridge achieves ultra clean burning without the need for fans, or other types of systems which require special operational methods or additional maintenance.

With its sustained burn cycle the new Woodsman Coleridge maximises burn time for each load of fuel giving you a longer burn and a more even comfortable heat compared to traditional low emission burners which burn through fuel faster and produce a more uneven heat output.

The 6mm steel plate cook top is perfect for use during a power outage or to just boil some water for a cup of tea. Consumable parts such as the baffle plate and rear air tubes are constructed from stainless steel for a longer service life and the simple baffle removal system ensures easy servicing for chimney sweeps.



**15 YRS
FULL FIREBOX
WARRANTY**



**2 YRS PARTS
WARRANTY**



COLERIDGE

PEDESTAL / LEGS

By Woodsman

SPECIFICATIONS

DIMENSIONS

PEDESTAL	823H x 615W x 638D
LEGS	823H x 648W x 638D

WEIGHT

PEDESTAL	145kg
LEGS	145kg

ULEB APPROVED

Yes

CLEAN AIR APPROVED

All Zones

FLOOR PROTECTOR

Ash Hearth

DIMENSIONS

PEDESTAL

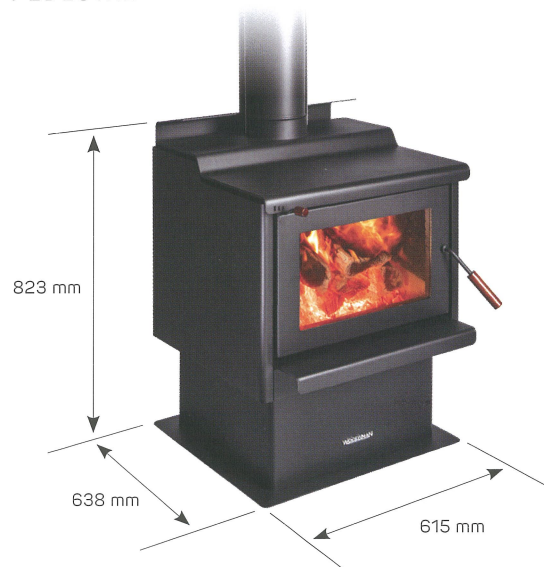

LEGS

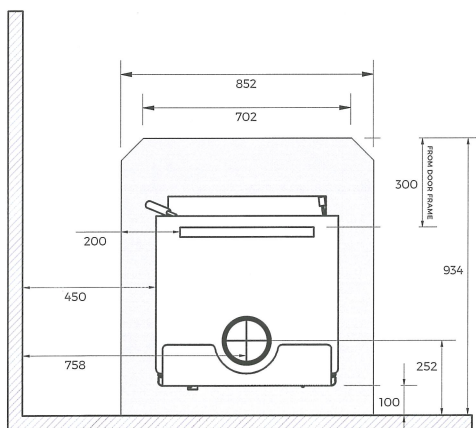
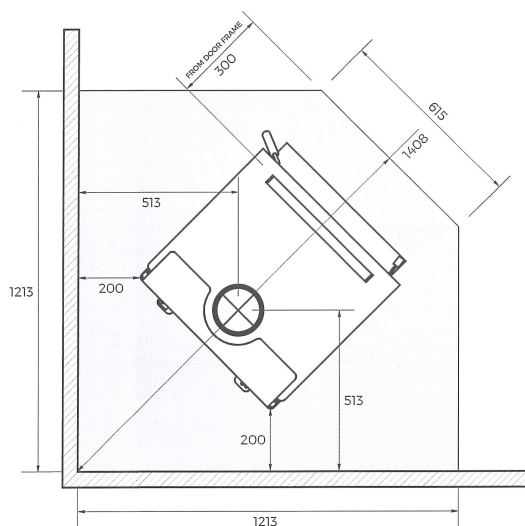

All dimensions and clearances are in mm. Clearances are with factory flue shield. Side dimension clearance from top plate. Refer to installation manual for full specifications.



New Zealand's leading supplier
of advice and fires.

W H Harris Ltd.
41 Braddon Street
Addington
Christchurch 8024
New Zealand

Phone +64 3 366 1796
Freephone 0800 366 1796
Fax +64 3 366 1795
sales@hhf.co.nz
www.woodsman.co.nz

